

7/10/2022, 10:41:11 AM, C:\LIBRARY\DEFAULT\DESKTOP-C\IC\INTEGRATED DEVELOPMENT PARTNERS, LLC\IDP - DATA\PROJECTS\2022\04-14 SITE PLAN - OVERALL - SITE PLAN_2022-07-08.DWG, 14 SITE PLAN - OVERALL

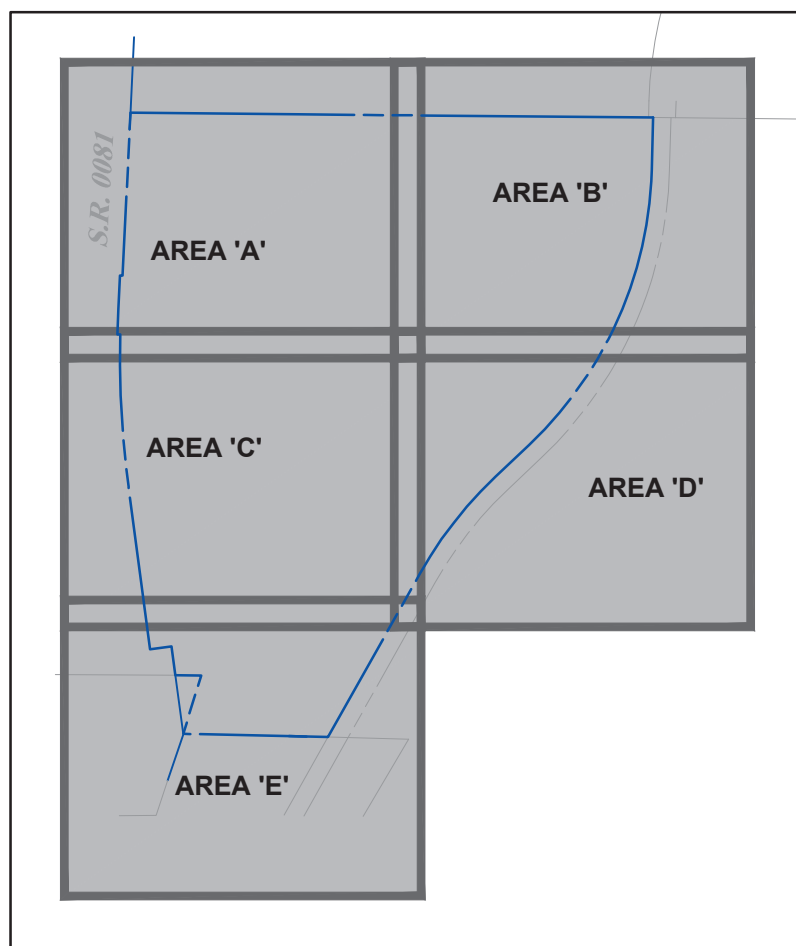
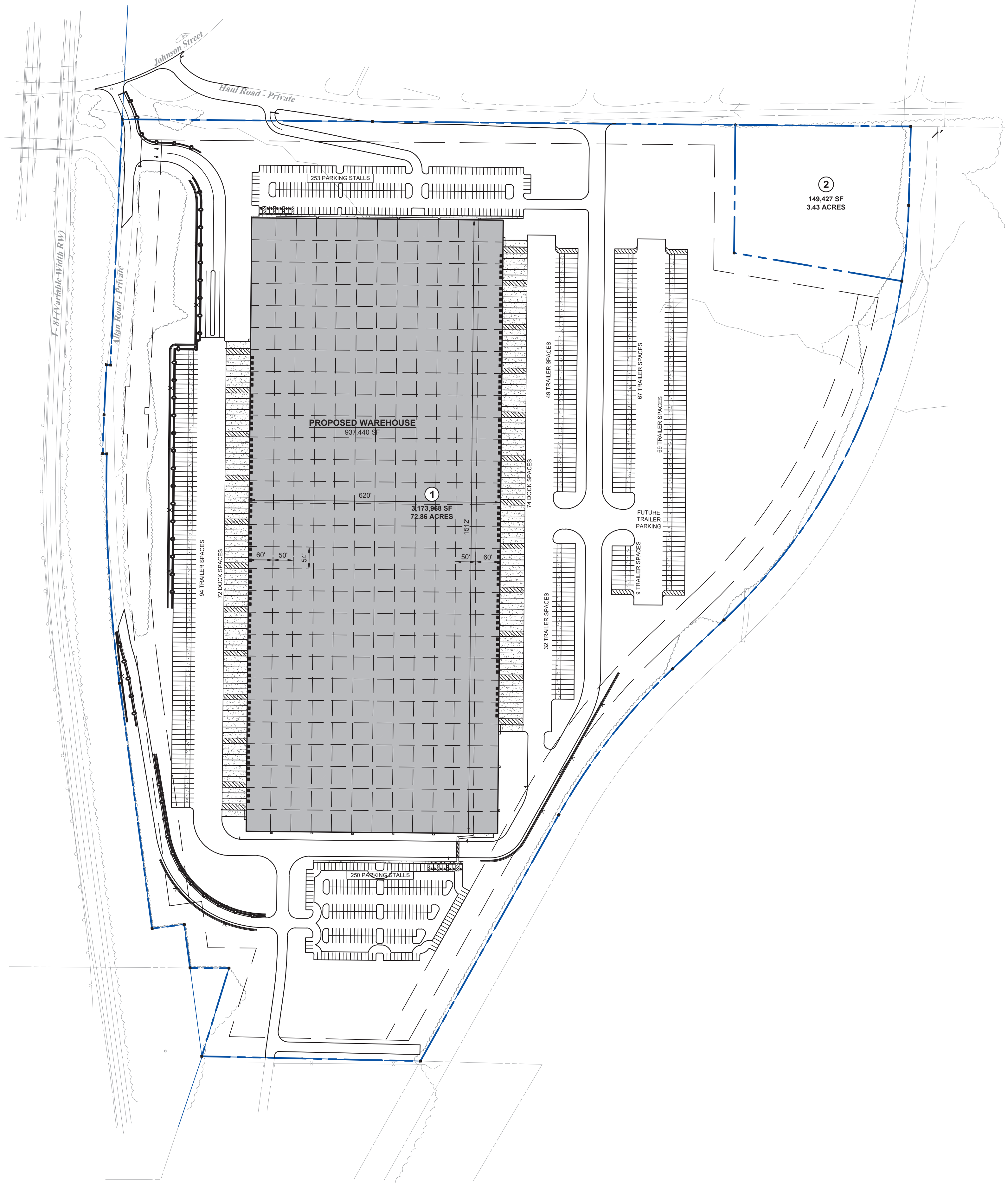

KEY MAP
SCALE: NONE

SITE PLAN NOTES

1. THE CONTRACTOR SHALL FOLLOW THE SEQUENCE OF CONSTRUCTION NOTES PROVIDED ON THE SEDIMENT AND EROSION CONTROL PLAN.
2. THE CONTRACTOR SHALL REFERENCE ARCHITECTURAL PLANS FOR EXACT DIMENSIONS AND CONSTRUCTION DETAILS OF BUILDING, THE CONCRETE SIDEWALKS, LANDINGS, RAMPS, AND STAIRS.
3. ALL SITE DIMENSIONS ARE REFERENCED TO THE FACE OF CURBS OR EDGE OF PAVING AS APPLICABLE UNLESS OTHERWISE NOTED. ALL BUILDING DIMENSIONS ARE REFERENCED TO THE OUTSIDE FACE OF THE STRUCTURE.
4. THE CONTRACTOR SHALL PROVIDE AND MAINTAIN TRAFFIC DEVICES FOR PROTECTION OF VEHICLES AND PEDESTRIANS AS REQUIRED BY THE OWNER, ENGINEER OR LOCAL GOVERNING AUTHORITIES.
5. TRAFFIC CONTROL SIGNAGE SHALL CONFORM TO THE STATE DOT STANDARD DETAIL SHEETS AND THE MANUAL OF UNIFORM TRAFFIC CONTROL DEVICES. SIGNS SHALL BE INSTALLED PLUMB WITH THE EDGE OF THE SIGN 2' OFF THE FACE OF THE CURB, AND WITH 7" VERTICAL CLEARANCE UNLESS OTHERWISE DETAILED OR NOTED.
6. PAVEMENT MARKING KEY:
 4" SYDL 4" SOLID YELLOW DOUBLE LINE
 4" SYL 4" SOLID YELLOW LINE
 4" SWL 4" SOLID WHITE LINE
 12" SWSB 12" SOLID WHITE STOP BAR
7. PARKING SPACES SHALL BE STRIPED WITH 4" SWL; HATCHED AREA SHALL BE STRIPED WITH 4" SWL AT A 45° ANGLE, 2" ON CENTER. HATCHING, SYMBOLS, AND STRIPING FOR HANDICAPPED SPACES SHALL BE PAINTED WHITE. OTHER MARKINGS SHALL BE PAINTED WHITE OR AS NOTED.
8. PAVEMENT MARKINGS SHALL BE HOT APPLIED TYPE IN ACCORDANCE WITH STATE DOT SPECIFICATIONS, UNLESS WHERE EPOXY RESIN PAVEMENT MARKINGS ARE INDICATED.
9. THE CONTRACTOR SHALL REMOVE CONFLICTING PAVEMENT MARKINGS IN THE ROADWAY BY METHOD APPROVED BY THE AUTHORITY HAVING JURISDICTION OR PENNDOT AS APPLICABLE FOR THE LOCATION OF THE WORK.
10. ALL ADA DESIGNATED PARKING STALLS, ACCESS AISLES AND PEDESTRIAN WALKWAYS SHALL CONFORM TO THE CURRENT VERSION OF THE AMERICANS WITH DISABILITIES ACT STANDARDS FOR ACCESSIBLE DESIGN AND ANSI STANDARDS AND MAY BE SUPERCEDED BY THE STATE BUILDING CODE.
11. CONSTRUCTION OCCURRING ON THIS SITE SHALL COMPLY WITH NFPA 241 STANDARD FOR SAFEGUARDING CONSTRUCTION, ALTERATION AND DEMOLITION OPERATIONS, AND CHAPTER 16 OF NFPA 1 UNIFORM FIRE CODE.
12. ALL CURB RADII SHALL BE 5' RADII UNLESS OTHERWISE SPECIFIED.

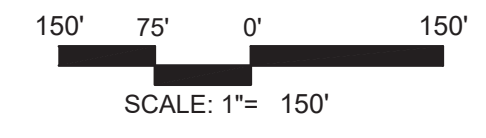
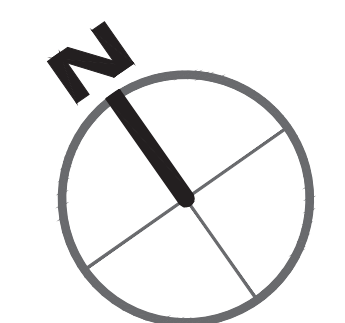

PROFESSIONAL SEAL

DRAWN	AML/MLS
REVIEWED	ILK
SCALE	AS NOTED
DATE	04/08/2022
PROJECT NO.	21-0161
CAD FILE:	04 - SITE PLAN_2022-07-08

REVISIONS NO.	DATE	DESCRIPTION

TITLE
SITE PLAN - OVERALL